



BRADFORD  
BAR & NIGHTCLUB



# NIGHTRAIN

## VENUE PACK

2026





# CONTENTS

## **1.CONTACTS & LOCATION**

CONTACTS

ADDRESS

PARKING

BY CAR

PUBLIC TRANSPORT

BY TRAIN / TAXI

## **2.VENUE DIRECTIONS FOR ARTISTS**

LOAD IN

CAZ CHARGE

## **3.INTERNAL ACCESS AND FACILITIES**

CAPACITY

STAGE DIMENSIONS

TIMES

DRESSING ROOM

LIVE ROOM FLOOR PLAN

## **4.PA SPEC**

FRONT OF HOUSE

MONITORS

CONTROL

MICROPHONES & DI BOXES

STANDS

LIGHTING DESK

LIGHTS & EFFECTS

## **5.RECOMMENDED HOTEL**





# 1. CONTACTS & LOCATIONS

## CONTACTS

**For bookings and production**  
[keith.tempest@nightrain.co.uk](mailto:keith.tempest@nightrain.co.uk)

**Venue**  
07858 851705  
[info@nightrain.co.uk](mailto:info@nightrain.co.uk)

## ADDRESS

 Nightrain, 7-19 Queensgate, Bradford BD1 1RB

# TRAVELLING



## PARKING

Nearby pay & display parking is available on Cheapside BD1 4HP.  
Midland Hotel - Pay on the RingGo App - £5.00  
Alternative parking can be found at the Broadway car park (BD1 1JR).  
Please note this car park closes at 1am.  
**Parking is only a short walk to the venue.**



## BY CAR

We are located on Queensgate which is a pedestrianised area.  
Please see above for nearby parking options.



## PUBLIC TRANSPORT

Bradford Interchange (6 minutes walk)



## BY TRAIN / TAXI

Bradford Forster Square (5 minutes walk)  
Bradford Interchange (6 minutes walk)

Taxi pick up /drop off point - Shoulder of Mutton Pub BD1 1QL



## 2. DIRECTIONS FOR ARTISTS

### VENUE ADDRESS

7-19 Queensgate, Bradford BD1 1RB

UNLOADING DIRECTLY OUTSIDE NIGHTRAIN FROM 16:30pm.

### POSTCODE TO USE FOR LOAD IN :-

BD1 1QL which is Kirkgate (shoulder of mutton pub)  
Drive Straight forward onto the precinct up to the barriers  
(BLACK LINE ON THE MAP).

Use the intercom button at the barriers,  
quote Nightrain to allow direct access to outside the venue.

100yds on you will see Betfred on the corner,  
turn a left down Queensgate and you are at NIGHTRAIN.

### PARKING:-

Exit Nightrain for parking follow the RED LINE on the Map.  
Parking after soundcheck etc is £1 after 6pm see BLUE LINES ON MAP.  
There will be someone always at the venue to advise on this also.

### TOUR BUSES/NIGHTLINERS

Please email at least 4 weeks prior to the event date,  
so we can accommodate accordingly.

Please note if required **'The Midland Hotel'**  
our recommended accommodation is on the map  
approx. 4 minutes walk to the venue.





# 2.1 CAZ CHARGE - CLEAN AIR ZONE

Bradford has a Class C+ Clean Air Zone.

Passenger cars will not be charged to drive in the Bradford Clean Air Zone. There will be charges for all non-compliant vehicle types.

You can use the government website by [clicking here](#), to check whether charges will apply to your vehicle in Bradford.

## **Pay a CAZ charge**

Payment must be made online at [www.gov.uk/clean-air-zones](http://www.gov.uk/clean-air-zones) or by calling the National Contact Centre on [0300 029 8888](tel:03000298888) (Monday to Friday, 8am to 8pm, and Saturday, 8am to 4pm).

You can pay 6 days before the day of your visit, on the day of your visit or up to 6 days after the day of your visit.

A 'day' is classified as midnight to midnight, not 24 hours from when you enter the zone. During that midnight to midnight timeframe, you can enter and leave the zone numerous times and only incur a single charge. However if you cross the midnight threshold you will be charged for two days.

You will not receive a notification or alert advising you that you have entered the zone and payment is due; you as a driver are fully responsible for understanding and managing all payments.

You will receive a £120 penalty charge plus the road user charge if you drive a non-compliant vehicle in the Bradford CAZ and fail to pay any daily charge due within the payment window.



# 3. INTERNAL ACCESS & FACILITIES

## CAPACITY

The venue is 500 sellable capacity.

## STAGE DIMENSIONS

Stage - 8.5m x 7.5m x 3.0m (W x D x H)

Drum Riser – 2.4m x 2.4m x 0.3m (W x D x H)

## TIMES

|                               |        |
|-------------------------------|--------|
| Standard Load In              | 16:30* |
| Standard Sound Check          | 17:30* |
| Earliest Doors Open to Public | 19:00* |
| Standard Curfew               | 23:15* |
| Standard Load Out             | 00:30* |

## SECURE EQUIPMENT STORAGE AREA



## LOAD IN

The venue is located on ground level. The load in is through the main entrance direct to the stage area.

## DRESSING ROOMS

There are two backstage areas available one with a private toilet for headline touring acts.



## WIFI

## SECURE BACKSTAGE AREA



# LIVE ROOM FLOOR PLAN NIGHTRAIN

## **BAND ROUTE**

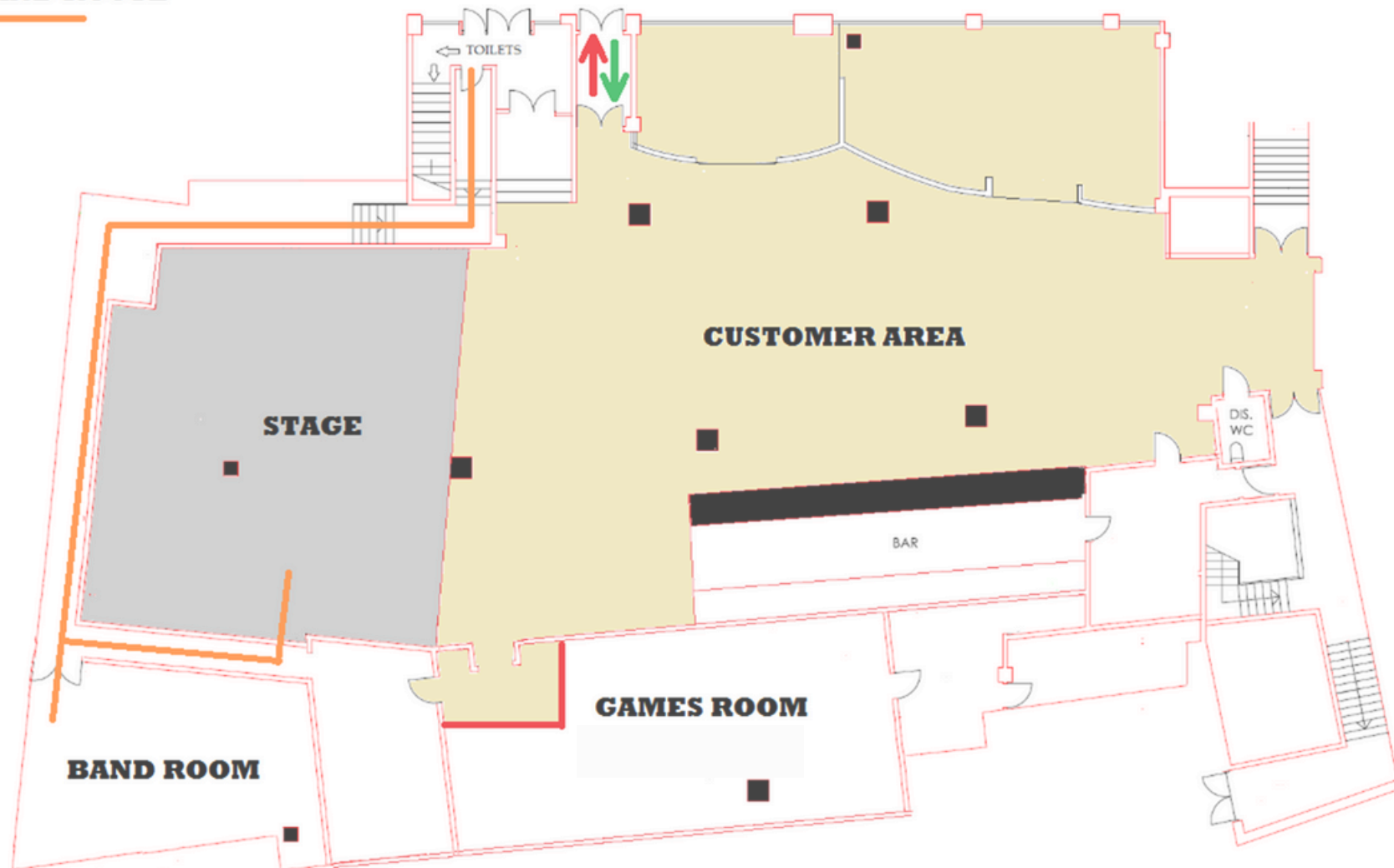



# 4. VENUE SPEC

## P.A System

4 x HK linear 4000A SUBS  
2 x HK Linear 1800 SUBS  
4 x HK Linear 5 115 FA TOPS

## In-Fill Speakers

2 x HK Linear 5 112 FA

## Stage

4 x HK Pro 12 XD Monitors  
2 x HK Pro 15 XD Monitors  
6 x Klark Teknik DN100 Direct Injection Box  
6 x On Stage DB500 Passive DI Box  
A Wide Range of Stands  
Drum Fill - JBL P749 Subwoofer 18inch  
2 x JBL 1725AP Tops  
32A 3 Phase 5 Pin Power Outlet  
Multiple 13A 240V Sockets



## Engineering

ALLEN & HEATH SQ-6 XCVI 96kHz  
FPGA engine 48 Channel/36 Bus Digital Mixer  
ALLEN & HEATH 2 x 16 XLR Input  
8 XLR Output 96kHz Portable DX Expander

## Stage Lighting

6 x Lanta Tumbler Moving Heads  
10 x Q colour LED Light Units  
3 x Chauvet P7 Geysers  
ChamSys MagicQ PC Wing Compact Lighting Desk  
Touch Screen Laptop with ChamSys Software  
2 x Lanta Quantum 384 lighting controllers  
Chauvet Hurricane Haze 4D  
6 x Sunstrip Active MK2 Blinders

## Microphones

4x Shure BETA 58A Dynamic Microphone  
2x Shure KSM8 Dualdyne Cardioid Dynamic Microphone  
2x Sennheiser E935 Dynamic Cardioid Microphone  
Lewitt MTP 550 Dynamic Microphone  
2x Shure BETA 52A Kick Drum Microphone  
Shure BETA 91A Condenser Kick Drum Microphone  
4x Sennheiser 604 Clip On Drum Microphone  
4x Sennheiser E614 Overhead Condenser Microphone  
2x Sennheiser E906 Cab Microphone  
4x Shure SM57 Dynamic Instrument Microphone

## Equipment for Hire

Pearl Decade Maple 7Pc Pro Drum Kit  
Marshall MX412BR 4 x 12 Straight Speaker Cab  
Marshall MX412AR 4x12 Angled Speaker Cab  
Marshall DSL 100HR 100W Valve Head x 2  
Ashdown Original HD-1-500 Bass Head  
Ashdown ABM-410H-EVO IV 650W 4x10" 8 Ohm  
Bass Cab



## General Venue Information

*Capacity: 500  
Full In-house Sound and Lighting  
Engineering Available*

*Easy Load in – All one Level Direct to Stage  
Lockable Storage Room (Equipment)*

*2 x Secure Band/Dressing Rooms with Direct  
Stage Access.*

*32 AMP 3 Phase N/E Socket for Touring  
Vehicles (Please enquire)*







## The Midland Hotel

The Midland Hotel is Situated in the heart of Bradford, 100m from Bradford Forster Square Station, and proud to have an AA Merit score of 80%.

The Midland has 90 Executive, Premium and Standard Bedrooms fully equipped with En Suite facilities, Sky TV, Ironing and Trouser Press in each room. Feature rooms include interconnecting Family Suites and Four Poster Rooms.

There is ample car parking on site as well as electric charging points available, free for our residents. If you are driving a commercial vehicle that doesn't meet Euro 4 or 6 please be aware we are inside the Bradford clean air zone.

Free ultra-fast WiFi

Our super fast connection delivers 500Mbps, we are the only hotel in Bradford currently offering DarkLight for our conferences and residential guests.

# S. HOTEL

The Midland Hotel  
Forster Square  
Bradford  
West Yorkshire  
BD1 4HU

## To Book Today

☎ [01274 735735](tel:01274735735)



[rooms@midland-hotel-bradford.com](mailto:rooms@midland-hotel-bradford.com)

## Quote **NIGHTRAIN** for Special Offers

